

THT-100CSTG Transparent Full Height Turnstile



Security with a clear view

With Boon Edam's THT-100CSTG transparent turnstiles, you don't have to sacrifice aesthetics for high security entrance control. Transparent arms and shields create an open appearance and all models are compatible with any access control system.

The THT-100CSTG incorporates three large clear Lexan panels per rotor section with the same material used for the dual shields on each side. Standard feature is a large, curved Lexan shield on each side, while a segmented shield design (shown above) is also available.

The CSTG is ideal for indoor applications requiring moderate throughput as two-way traffic is allowed in one direction at a time.

'Large, clear panels and shields create an open appearance'

Construction

- Available in anodized aluminum. Panels are fabricated from 3/4" thick transparent material. Maximum open space between arms is 5" to prevent access.
- All materials meet ASTM standards.
- Hydraulic dampener controls rotation speed, ensures smooth operation, reduces vandalism and increases operating life even under the toughest conditions.
- Sealed top and bottom bearings provide free, easy rotation even in challenging environments.
- Electric turnstiles use a heavy duty electromechanical ratchet and pawl operating mechanism to restrict traffic flow.

Dimensions

Model	Height	Width	Depth	Interior Height	Shipping Wt.
THT-100CSTG	89"	60"	52 5/16"	81"	1000 lbs.

THT-100CSTG FOOTPRINT

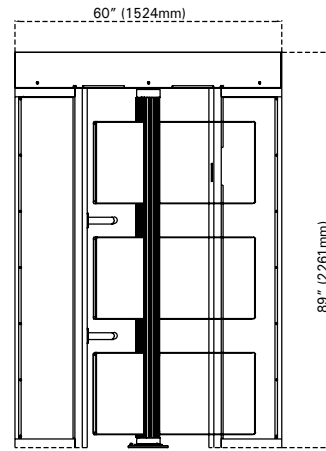
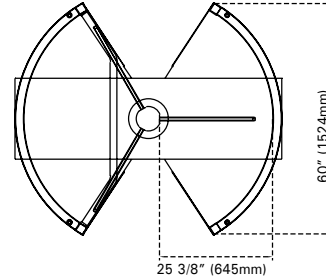

Features & options

Characteristics	Std	Opt
Free or Locked Exit (for mechanical direction)	•	
Fail Lock or Fail Safe (for electrical direction)	•	
Pulse Relay	•	
Hydraulic Speed Control	•	
Time-Out Relay	•	
Key Bypass		•
Remote Pushbutton		•
Home Position Switch		•
Rotation Detection Switch		•
Key Bypass*		•
Red & Green Indicator Lights		•
Heel Protectors		•
Card Reader Box		•

*Key Bypass is standard with a Fail Lock configuration.

Technical specifications

Power supply ¹	110 VAC (220 VAC optional), 50/60 Hz Converted to 24 Volt
Power consumption ¹	Less than 1 amp at 110 VAC
Working temperature	5°F to 110°F
Connection	The electrical full height turnstile communicates with most authorization systems using potential free contacts.

¹Only for electrical models

